

# Terminale cabluri



**Automatizari**  
electrice si pneumatice



Standard: EN 61 238-1

**Non-insulated butt terminals – with coating for crimping**

They are copper pipe with galvanic tin coating. They are used for joining of copper conductors – rigid or multiple conductors with different section. The connection is accomplished through crimping pliers, through mechanical pressing of the butt terminals and the conductor.

**Technical data:**

- \* Material: copper alloy
- \* Coating: tin
- \* Application: general



Type	Length L (mm)	Outer diameter D (mm)	Inner diameter d (mm)	Cable (mm <sup>2</sup> )	Catalogue number
GTY-4	20	5	3	4	59213
GTY-6	25	5.3	3.7	6	59201
GTY-10	30	6.3	4.5	10	59202
GTY-16	35	7.5	5.7	16	59203
GTY-25	40	9	7.2	25	59204
GTY-35	45	10.8	8.5	35	59205
GTY-50	50	12.5	9.8	50	59206
GTY-70	55	14.5	11.5	70	59207
GTY-95	60	17	13.7	95	59208
GTY-120	65	19	15	120	59209
GTY-150	70	21	16.7	150	59210
GTY-185	75	23	18.5	185	59211
GTY-240	80	26	21	240	59212



Standard: EN 61 238-1

**Bimetal non-insulated butt terminals – with coating for crimping**

They are pipe made of two metals – copper and aluminum without galvanic coating. They are designed for joining copper and aluminum conductors – rigid or multiple conductors with different section. The connection is accomplished through crimping pliers, through mechanical pressing of the butt terminals and the conductor. They are used for protection against electrochemical corrosion got at two metals contact with different chemical properties and conductivity at electrical current feed. They are manufactured under modern technology and have high quality and long exploitation period.

**Technical data:**

- \* Material: copper aluminum alloy
- \* Coating: none
- \* Application: general for joining of two types of conductors

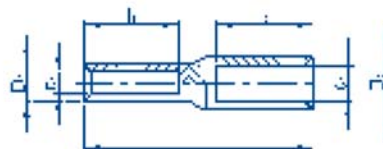

Butt terminal type	d1	D1	d2	D2	l1	l2	L	Catalogue number
GTL - 1- 16	5	9	6	10	30	30	75	59214
GTL - 1- 25	6	10	7	12	30	33	82	59215
GTL - 1- 35	7	11	8.5	14	30	40	90	59216
GTL - 1- 50	8.5	13	9.8	16	32	42	95	59217
GTL - 1- 70	9.5	15	11.5	18	38	50	105	59218
GTL - 1- 95	11.5	17	13.5	21	40	50	110	59219
GTL - 1- 120	13.5	19	15	23	42	55	112	59220
GTL - 1- 150	15	21	17	25	44	55	118	59221
GTL - 1- 185	17	23	18.5	27	46	60	125	59222
GTL - 1- 240	19	26	21	30	54	60	130	59223





Standard: EN 61 238-1

**Non-insulated cable terminals with coating for crimping**

They are used for joining copper conductors - multiple conductors with different section to electrical devices or connections to combine all cores of the conductor, to provide safe connection at tightening in terminals and safe connection at the base of the terminal. Thus the connection stability against vibrations is increased and the possibility for short circuit is decreased. They are made of copper alloy with galvanic tin coating. The connection is realized through crimping pliers, through mechanic pressing of the terminal and conductor. Two types are offered with standard length and extended base. They are manufactured under modern technology and have high quality and long exploitation period.

**Technical data:**

- \* Material: copper alloy
- \* Coating: tin
- \* Application: general for joining conductors to electrical devices.

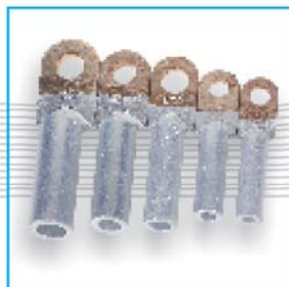

Standard: EN 61 238-1

**Bimetal non-insulated cable terminals for crimping**

They are used for joining aluminum conductors - multiple conductors with different section to electrical devices or connections to combine all cores of the conductor, to provide safe connection at tightening in terminals and safe connection at the base of the terminal. Thus the connection stability against vibrations is increased and the possibility for short circuit is decreased. They are made of copper and aluminum alloys as in the aluminum billet is made under special technology the copper terminal formed like an ear. The connection is realized through crimping pliers, through mechanic pressing of the terminal and conductor. They are manufactured under modern technology and have high quality and long exploitation period.

**Technical data:**

- \* Material: copper aluminum
- \* Application: general for joining conductors to electrical devices.

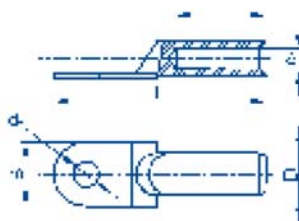
**Dimensions:****Non-insulated cable terminals for crimping**

Shoe type	d1 (mm)	D (mm)	d2 (mm)	L (mm)	Catalogue number
JM - 2.5	2.2	4.5	6	24	59240
JM - 4	3.0	4.8	6	24	59241
JM - 6	3.8	5.5	6	24	59035
JM - 6	3.8	5.5	8	24	59059
JM - 10	4.8	6.8	6	25.5	59036
JM - 10	4.8	6.8	8	25.5	59037
JM - 16	5.5	7.5	6	30.5	59038
JM - 16	5.5	7.5	8	30.5	59039
JM - 16	5.5	7.5	10	30.5	59040
JM - 25	7	9	8	34	59041
JM - 25	7	9	10	34	59042
JM - 35	8.2	10.5	8	38	59043
JM - 35	8.2	10.5	10	38	59044
JM - 35	8.2	10.5	12	38	59045
JM - 50	9.8	12.5	8	45	59046
JM - 50	9.8	12.5	10	45	59047
JM - 50	9.8	12.5	12	45	59048
JM - 70	11.5	14.5	10	50	59049
JM - 70	11.5	14.5	12	50	59050
JM - 95	13.8	17.5	10	55.5	59051
JM - 95	13.8	17.5	12	55.5	59052
JM - 120	15.5	19.5	10	63	59053
JM - 120	15.5	19.5	12	63	59054
JM - 150	16.5	21	12	71	59055
JM - 185	18.8	23.5	12	78	59056
JM - 185	18.8	23.5	16	78	59057
JM - 240	21	26.5	16	92	59058

**Dimensions:****Bimetal non-insulated cable terminals for crimping**

Shoe type	d1 (mm)	D (mm)	d2 (mm)	L (mm)	I (mm)	B (mm)	Catalogue number
DTL - 16	6	11	8	70	30	16	59224
DTL - 25	7	12	8	75	34	18	59225
DTL - 35	8.5	14	10	85	38	20.5	59226
DTL - 50	9.8	16	10	90	40	23	59227
DTL - 70	11.5	18	12	102	48	26	59228
DTL - 95	13.5	21	12	112	50	28	59229
DTL - 120	15	23	14	120	53	30	59230
DTL - 150	16.5	25	14	126	56	34	59231
DTL - 185	18.5	27	16	133	58	37	59232
DTL - 240	21	30	16	140	60	40	59233

## Insulated butt connectors



Standard: EN 61 238-1

They are cable butt terminal with cross section up to 6mm<sup>2</sup> with polyvinylchloride insulation. They are used for joining/extending multiple conductors with section up to 6mm. It increases the connection stability against vibrations and decreases the possibility for short circuit. The connection is realized through crimping pliers, through mechanic pressing of the terminal and conductor. The different insulation colour corresponds to different conductor sections. They are manufactured under modern technology and have high quality and long exploitation period.

## Technical data:

- \* Material: copper alloy
- \* Coating: polyvinylchloride
- \* Application: general for joining copper conductors

Colour	red		blue		yellow	
Length (mm)	16	25	16	25	20	25
Package (pcs.)	100	100	100	100	100	100
Type number	PVT 1.25	BV 1.25	PVT 2	BV 2	PVT 5.5	BV 5.5
Conductor (mm <sup>2</sup> )	1	1	1.5-2.5	1.5-2.5	4-6	4-6
Catalogue number	59015	59001	59034	59002	59014	59003

## Insulated cable terminals

They represent a cable terminal made of brass alloy with galvanic tin coating and insulated with polyvinylchloride. They are used as non-insulated terminals, as the insulated part protects the cores from bending and breaking in the joining point and at the same time it protects the staff from direct contact to the current leading elements. They are used for connectors with section up to 6mm. The connection is realized through crimping pliers, through mechanic pressing of the terminal and cable. The different insulation colour corresponds to different conductor sections. They are manufactured under modern technology and have high quality and long exploitation period. All insulated cable terminals are being offered in 100 pcs. packing

## Technical data:

- \* Material: copper alloy
- \* Coating: polyvinylchloride
- \* Application: general for joining copper conductors
- \* Ambient temperature: -10 to +75°C

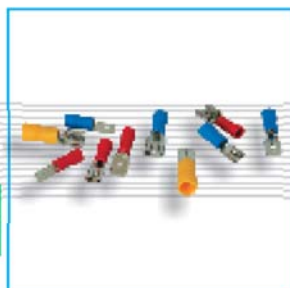

K3

MALE	MDD - red 1.25 - 187	MDD - red 1.25 - 250	MDD - blue 2 - 187	MDD - blue 2 - 250	MDD - yellow 5.5 - 250
Catalogue number	59012	59009	59013	59011	59010
FEMALE	FDD - red 1.25 - 187	FDD - red 1.25 - 250	FDD - blue 2 - 187	FDD - blue 2 - 250	FDD - yellow 5.5 - 250
Shoe width	187	250	187	250	250
Conductor (mm <sup>2</sup> )	1	1	1.5-2.5	1.5-2.5	4-6
Catalogue number	59008	59006	59007	59004	59005

Colour	white	blue	red	black	grey	orange	green	dark green	milky yellow	black	grey-yellow
Type	E0508	E7508	E1008	E1510	E2512	E4012	E6018	E10-18	E16-18	E25-16	E35-25
Terminal length (mm)	8	8	8	10	12	12	18	18	18	16	25
Conductor (mm <sup>2</sup> )	0.5	0.75	1.0	1.5	2.5	4.0	6.0	10	16	25	35
Catalogue number	59023	59024	59025	59026	59027	59028	59029	59030	59031	59032	59033



Colour	red		blue		yellow		
Type	RVL 1.25-4	RVL 1.25-5	RVL 2-4	RVL 2-5	RVL 5.5-4	RV 5.5-5	RV 5.5-6
Package (pcs.)	100	100	100	100	100	100	100
Size of the opening (mm)	4	5	4	5	4	5	6
Conductor (mm <sup>2</sup> )	1	1	1.5-2.5	1.5-2.5	4-6	4-6	4-6
Catalogue number	59021	59022	59018	59019	59020	59016	59017



## Insulated terminals



MALE	PTV - red 1.25 - 10	PTV - red 1.25 - 12	PTV - blue 2 - 10	PTV - blue 2 - 12	PTV - yellow 5.5 - 13
Shoe width	1.9	1.9	1.9	1.9	2.9
Conductor (mm <sup>2</sup> )	0.25-1.5	0.25-2.5	1.5-2.5	1.5-2.5	4-6
Catalogue number	59101	59102	59103	59104	59105



MALE	PBDD - red 1.25 - 250	PBDD - blue 2 - 250	PBDD - yellow 5.5 - 250
Shoe width	6.3	6.3	6.3
Conductor (mm <sup>2</sup> )	0.25-1.5	1.5-2.5	4-6
Catalogue number	59106	59107	59108



MALE	MPD - red 1.25 - 156	MPD - blue 2 - 195	MPD - yellow 5.5 - 195
Shoe width	6.3	6.3	6.3
Conductor (mm <sup>2</sup> )	0.25-1.5	1.5-2.5	4-6
Catalogue number	59109	59110	59111



MALE	MDFN - red 1.25 - 250	MDFN - blue 2 - 250	MDFN - yellow 5 - 250
Shoe width	4	4	5
Conductor (mm <sup>2</sup> )	0.25-1.5	1.5-2.5	4-6
Catalogue number	59112	59113	59114



Length (mm)	18.1	20.1	25.5	27.3
Package (pcs.)	100	100	100	100
Type number	CHS3	CHS4	CHS5	CHS6
Conductor (mm <sup>2</sup> )	0.25-1.5	1.5-2.5	4-6	8
Catalogue number	59115	59116	59117	59118

**CONTACT:**

DEVA:

Str. Imparat Traian nr 15/19, DEVA, jud Hunedoara

Tel/fax: 0254/226002, mobil: 0722-730504

TG-JIU:

Str. Victoriei nr 112, TG-JIU, jud Gorj

Tel/fax: 0353-402061, mobil: 0745-647476

Email: [contrax@automatizari.net](mailto:contrax@automatizari.net)

WEB: [www.automatizari.net](http://www.automatizari.net)

[www.rubberproducts.ro](http://www.rubberproducts.ro)